

Powerwall

space frame systems

4 Netherton Road, Wishaw, Lanarkshire, Scotland ML2 0EQ

Tel: +44 (0) 1698 373305 Fax: +44 (0) 1698 374503

e-mail: sales@powerwall.co.uk | www.powerwall.co.uk | www.powerwall.tv

Powerwall

renders & aggregates

company profile

Through continual technical development we are recognised as the industry leaders in Premixed Renders, Insulation Systems, Single Skin Walling Systems, Aluminium Honeycomb and Volumetric Building Systems.

Unsurpassed in quality and performance, the construction industry has come to know us as the professional's preferred choice. Our quality accreditations speak for themselves.

manufacturing design & technical support

Based in the UK we are committed to expanding our production facilities to handle an ever increasing demand for new and refurbishment projects from our purpose built facilities on a 15 acre site, South East of Glasgow, and a 60,000 square foot manufacturing facility based in Artegna, Udine, Italy.

To ensure our clients' projects are delivered to the highest standards and fully meet project specifications we offer a complete package of design, technical and site monitoring solutions from our in-house team.



Powerwall

renders & aggregates



fawn



grey



tan



terracotta



pink

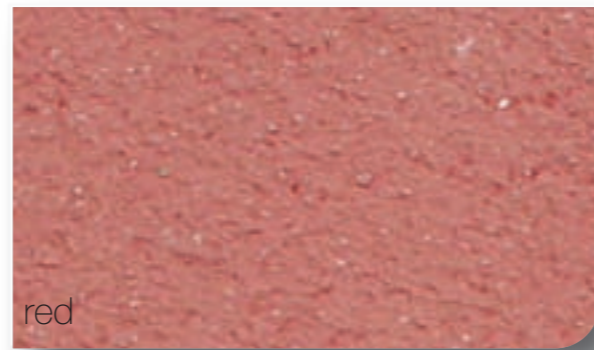

red



white



yellow

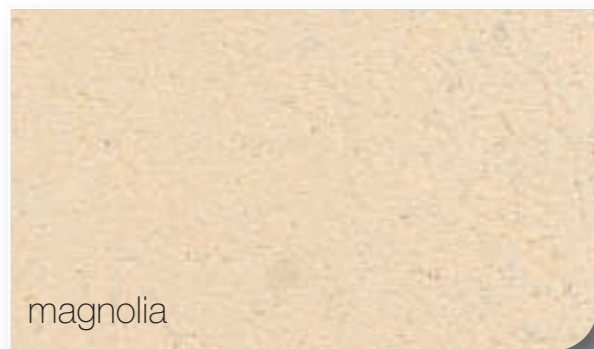

magnolia



peach

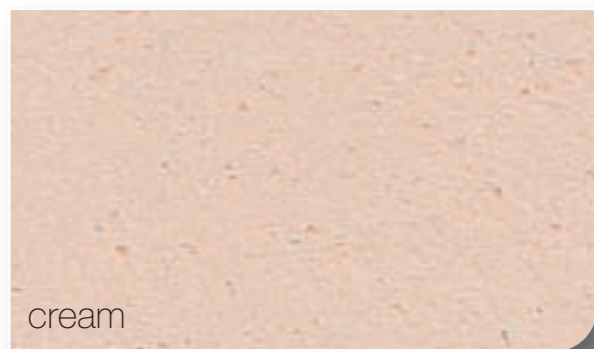

cream



deep pink

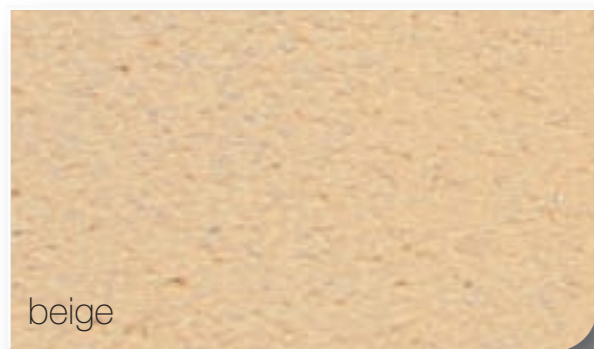

beige



brown

render finishes

Powerwall Space Frame Systems Ltd provides a highly specialised render range formulated to be protective, durable, waterproof and give an extraordinary aesthetic finish.

Our renders are self coloured giving the user an easily applicable product, which only requires the addition of water and on-site mixing to make ready for application.

Tried and tested, our products have been relied upon in the industry for over 35 years and have been successfully used in very diverse and innovative applications.

The sample colours shown are available in our traditional and polymer render.

For further information or assistance please call **+44 (0) 1698 373305** or visit **www.powerwall.co.uk**

*Renders are produced from natural materials and colours may vary.

Please note that certain products, colours and finishes are subject to a minimum order quantity please contact sales office for further information.

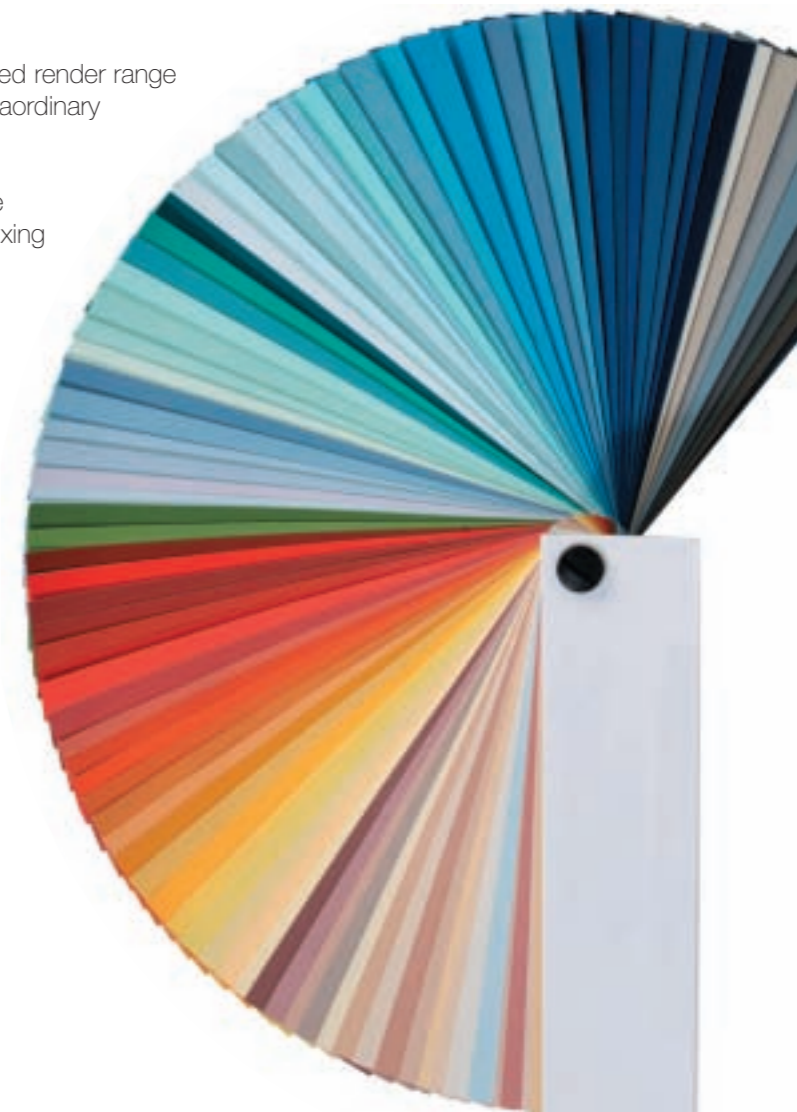

renders finishes

smoothband



- Pre-mixed blend of aggregates, synthetic resins, co-polymers, cement and fibres.
- Tough, flexible, waterproof and crack resistant.
- Excellent adhesive qualities.
- Can be applied to most substrates.
- Great workability - smooth in just one coat.

wet-dash



- Pre-mixed blend of fillers, synthetic resins, co-polymers, cement and fibres.
- Tough, flexible, waterproof and more crack resistant than traditional renders.
- Excellent adhesive qualities.

acrylic render



- Heavy duty, elastomeric structural decorative finishes.
- Suitable for most types of masonry and cement based bases.
- Most durable, weatherproof wall coatings in use today.
- Available in fine sand and coarse aggregate mixes.
- Choose from a wide variety of colours and textures.

dry-dash



- Special pre-mixed blend of aggregates, lightweight fillers, resin cement modifiers, co-polymers, fibres and cement.
- Tremendous adhesive qualities.
- High tensile and compressive strength.
- Ideal for one coat and dash applications.

brick slips



- True brick appearance - fired from natural clay.
- Light weight, fast build finish.
- Can be applied to almost any substrate.
- Available in a range of colours and textures.

classic stone/scratch render



- Carefully selected aggregates, colour fast pigments & additives.
- Create stone, ashlar and other effects by cutting to form joints and ashlar grooves.
- Decorative finish with excellent weather resistance and durability.
- Allows walls to breathe.

product Information

polymer renders

about

Our polymer render range has been developed with a range of specifications in mind and provides proven hi-tech polymer fibre reinforced renders suitable for most applications.

usage

This range is suitable for both new build and refurbishment projects and is regularly used as part of Powerwall's external insulation systems and cassette walling system.

preparation

The range can be applied to virtually any clean and moisture free surface.

strength

The range provides a virtually maintenance free finish and is available in an extensive range of colours to suit any application.

mixing & application

The polymer render can be easily applied traditionally or by a render pump just by adding water and paddle mixing on-site.

environment

The polymer render range is tried and tested in both residential and industrial environments.



surerend renders

about

Our surerend render range is part of our highly successful range of traditional renders manufactured from a blend of selected aggregates, sand, cement and additives.

Preparation

The range can be applied to virtually any clean and moisture free surface.

strength

Whilst surpassed by our fibre reinforced renders in terms of strength, the surerend still gives a high level of protection.

mixing & application

The surerend range, like the polymer range, needs only the addition of water and paddle mixing on-site, the range can then be applied traditionally or by a render pump.



acrylic renders

about

Our acrylic render is a 100% acrylic based product with integral colour pigments and specially selected marble aggregates. We have a range of over 200 colours to choose from in a choice of 1.5 - 2 mm aggregate.

application

The range has been designed to work in both new build and refurbishment projects. This product's flexible qualities mean that it is an ideal finish for use with Powerwall's external insulation systems and cassette walling system.

preparation

The range can be applied to virtually any clean and moisture free surface.

strength

The range uses quick cure technology to provide a highly flexible and waterproof finish.

mixing & application

Pre-mixed our unique acrylic renders can be applied either by trowel or by spray.



related products

micro emulsion sealer

Powerwall micro emulsion sealer is a clear, water based product, designed to repel water without forming a film. Formulated from a blend of siloxane and oligometric compounds, micro emulsion sealer will act as a water repellent to absorbent building materials such as brick, block, stone, render, plaster, limestone, sandstone, concrete etc.

fungicidal wash

Powerwall fungicidal wash is a low toxicity biocide recommended for use as an antifungal agent where high anti-microbial activity occurs. The product also contains detergents which help treat mildew, algae, fungi, lichens and mosses etc.

colourcoat penetrant

Powerwall colourcoat penetrant is a versatile coating material for external use, formulated from a blend of acrylic polymers and co-polymers, which is designed to penetrate the pores of the material and requires no maintenance.

It is an ideal topcoat for Powerwall through coloured, smoothband render, wet dash finish, concrete panels, cement plasters, concrete masonry, and most cement based backgrounds. In addition, colourcoat penetrant can be used as an intermediate primer for swirl finish. Colourcoat penetrant is normally a one coat application; however two coats may be required dependent on background colour and texture.

acrilplast colourcoat

Powerwall acrilplast colourcoat is a versatile flexible exterior masonry coating formulated from a blend of acrylic polymers and co-polymers. It is an ideal topcoat for Powerwall basecoat, smoothband render, wet dash finish, concrete panels, cement plasters, concrete masonry, brick work, blockwork and most cement based backgrounds. In addition, acrilplast colourcoat can be used as an intermediate primer for swirl finish and sand finish and is available in over 200 colours.

aggregates collection

Powerwall Aggregates are a selection of the finest aggregates sourced from all over the world. We were the first company to design and build a plant specifically for dry-dash and continually produce high quality aggregates for our industry.

Our aggregates are screened, washed, mixed, blended and bagged within our custom built plant. The unique in-house processing of these products enables us to specially design aggregates for application for the dry-dash industry.

Other aggregates are available on request.

For further information or assistance please call
+44 (0) 1698 373305 or visit www.powerwall.co.uk

*Aggregates are produced from natural materials and colours may vary.



regent 80/20



monarch



huntington beige



cyrus



sunset gold



ferno



rossa



derbyshire spar



dolowhite



russet



sky marble



harvest



tudor 80/20



champagne



durite



lanark red



tuscan



yellow sienna



jersey cream



ashton cream



maesteg



barley corn



brightstone cream



birch



buff



nordic white



cameo



coral



yellow sienna 50/50



dawn



associated products

Volumetric Space Frame

Powerwall Volumetric construction is a marrying of the Powerwall cassette walling system with the structural volumetric hot rolled construction, giving you all the advantages of the cassette walling system but applied in a factory environment. The benefits of Powerwall Volumetric construction are simple; quality control, no weather constraints, site safety and massively reduced site and building costs.

For further information or technical details please call:
+44 (0) 1698 373305 or view accompanying CD-ROM.



connector system

To join the modules together we use the Powerwall Connector System, designed to connect adjacent units in the top and bottom corners where the connector locks into the tubular steel frame.

Cassette Walling System

Powerwall have introduced a major advancement in building construction technology through our lightweight cost saving construction system. It marries light weight steel frame construction with excellent structural capabilities. This is ideal for use with Powerwall honeycomb panels in the construction of external load bearing walls, infill panels and partition walling, allowing traditional finishes to be applied, using modern methods. The system has many advantages, including:

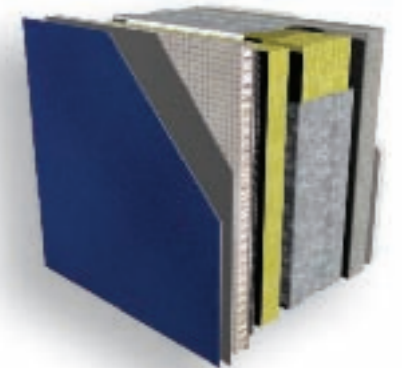

- Cost savings - the lightweight system is 30 kg/m² for external walls excluding external finishes which leads to cost saving on the foundations. The fast build method leads to site cost reductions.
- Thermal efficiency - a minimum U Value of 0.22W/m².K is achieved.
- Resourcing - much lower use of traditional building skills is required.
- Reduced environmental impact - environmentally friendly and fully recyclable as it offers an excellent alternative to timber.

finishes

From brick-slip to render to stone cladding Powerwall can supply a huge variety of finishes depending on the specification required, giving you a one stop shop for the entire build.

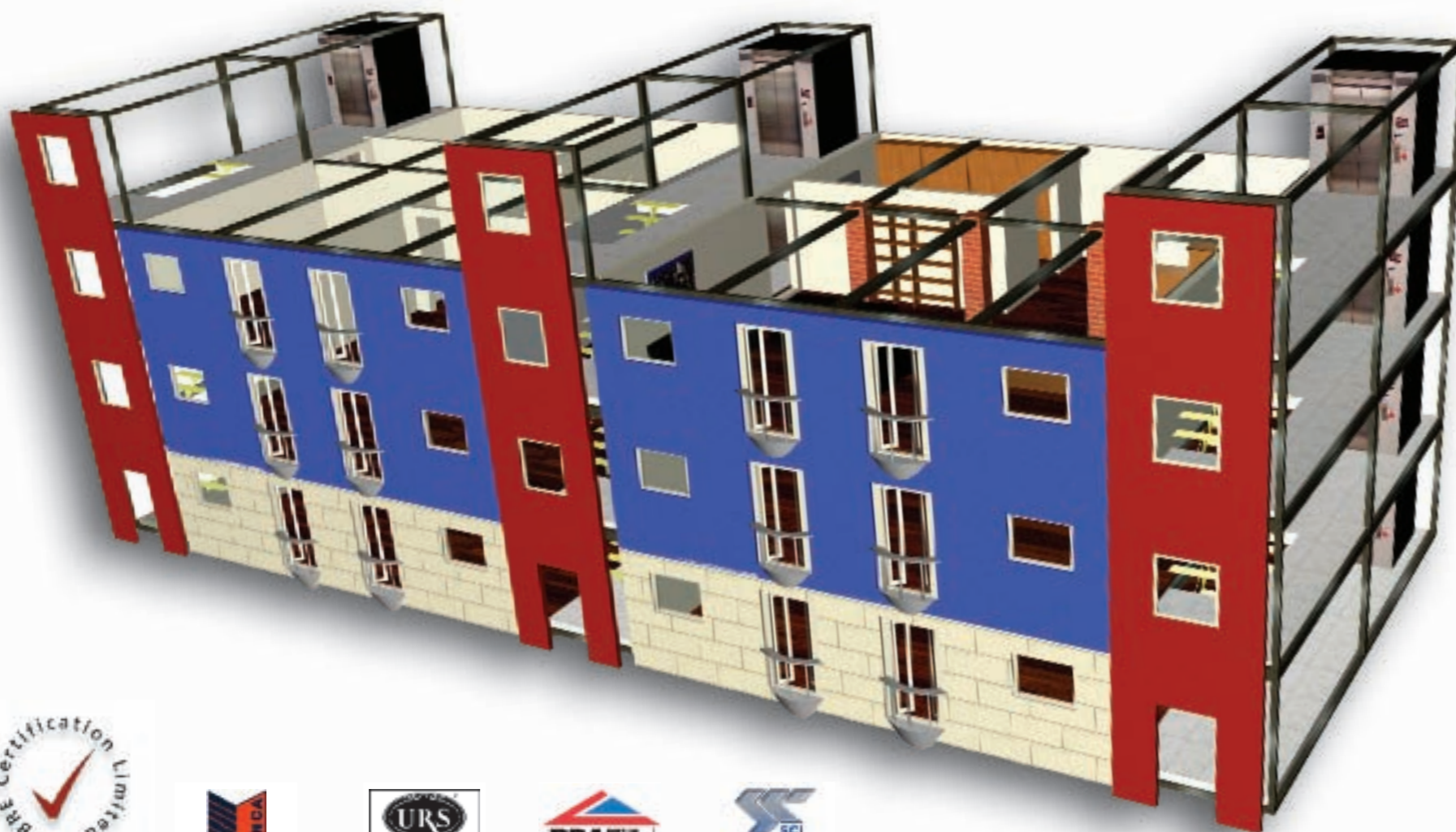

BRE Tested



* BRE Certification and Logo use applies only to Powerwall Honeycomb Cassette Walling System.

